

MALDIVES LAND SURVEY AUTHORITY

MINISTRY OF HOUSING AND INFRASTRUCTURE
 Office (PABX): +(960) 3004300, Fax: +(960) 3004254
 Email: survey@housing.gov.mv
 Web: www.surveyofmaldives.gov.mv,
 Ameenee Magu, Maafannu, Male', 20392, Maldives.



| | | |
|---|-----------------------|----------|
| CONTROL POINT DETAILS | Station Number | PSM 5145 |
| Coordinate Information | | |
| Geodetic | Grid | |
| WGS 84 | UTM Zone 43 | |
| Lat: 3°28'30.97720"N | E: 258771.664m | |
| Long: 72°49'43.29911"E | N: 384403.815m | |
| Ellp Height: -82.735 | Orth Height: + 0.889 | |
| Island Name: ADH. Holiday Island Resort & Spa | Date: 7th August 2021 | |

Monument description & method of survey:

- Monument Type A as in Technical Brief
- Stainless steel plate fixed to concrete by Four bolts
- Horizontal coordinates fixed by GNSS Static survey.
- Vertical height corrected using tide prediction data (Hulhule)
- PSM 5145 is 0.3m below ground Level

General site condition & access:

- Easily accessible area with wide angle of sky visibility
- Located at the east side harbor quaywall
- Situated near the Harbor Quay wall bend

Owner: ADH. Holiday Island Resort & Spa

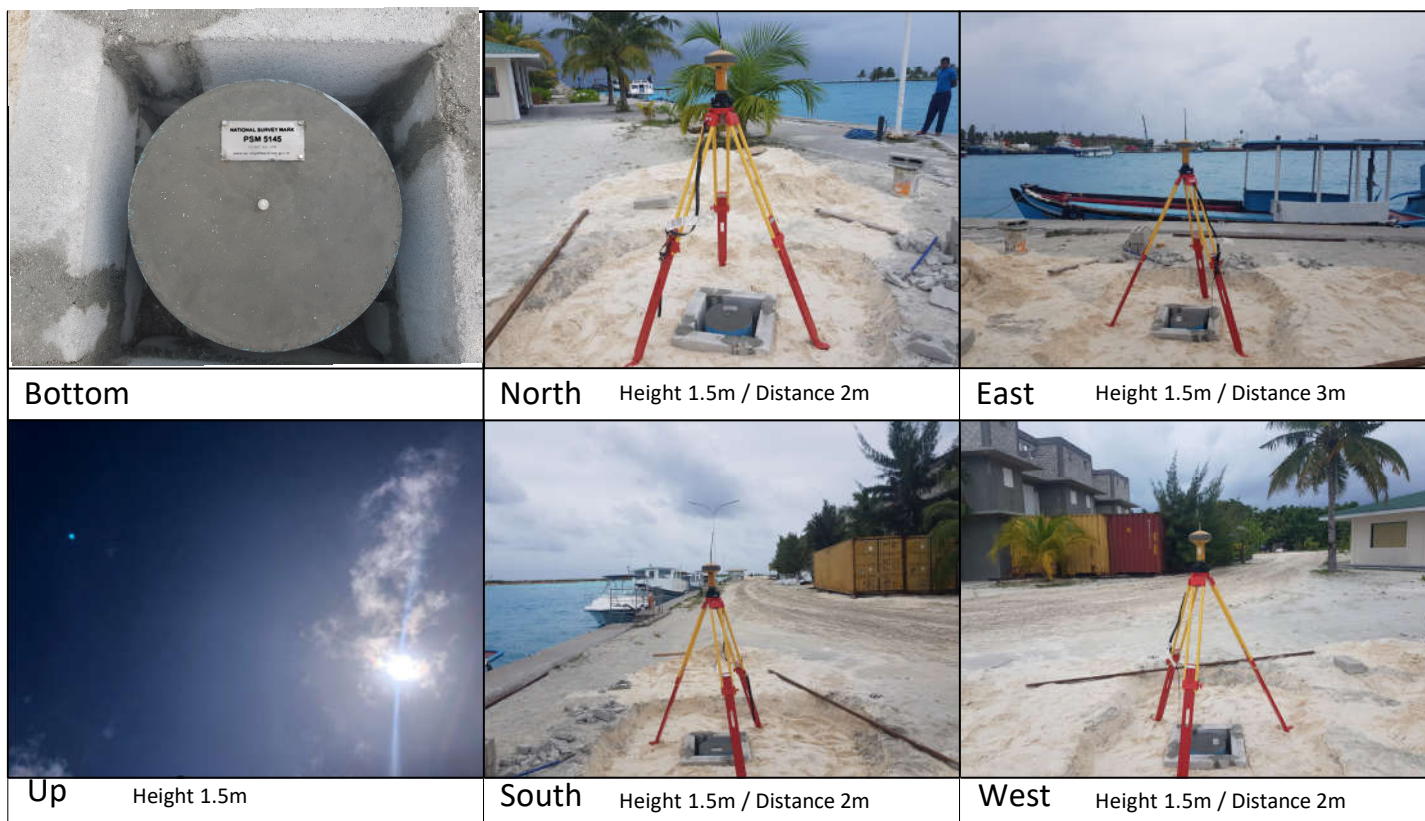

SITE INFORMATION

Station Number

| | | | | | | |
|---|---|---|---|---|---|---|
| P | S | M | 5 | 1 | 4 | 5 |
|---|---|---|---|---|---|---|

Station Horizon Mask

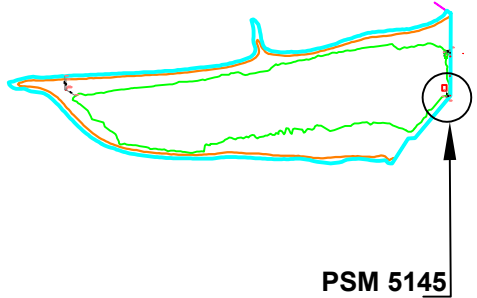
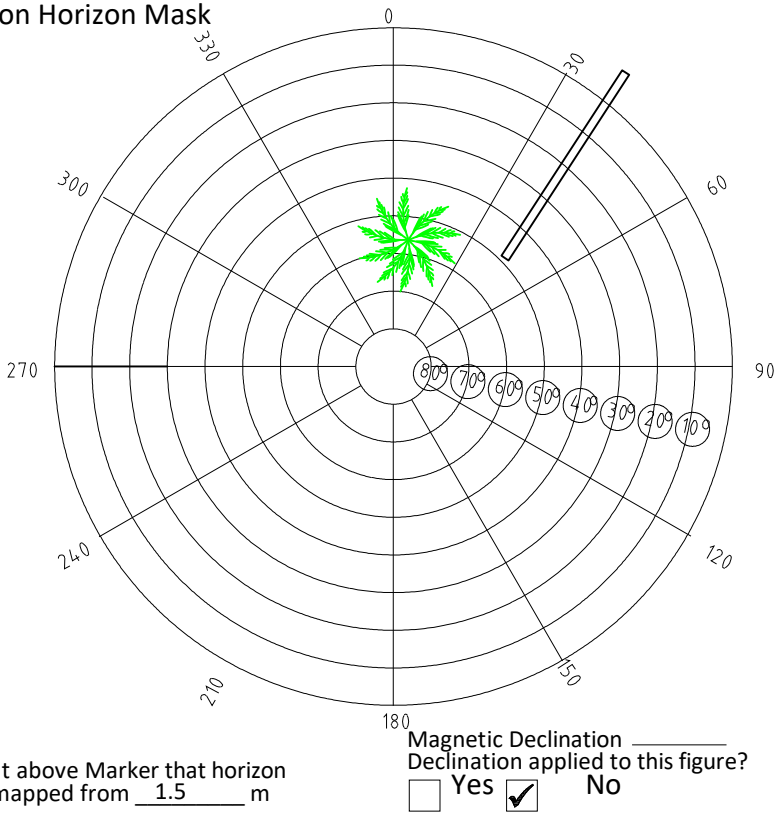

Height above Marker that horizon was mapped from 1.5 m

Magnetic Declination _____
 Declination applied to this figure?
 Yes No

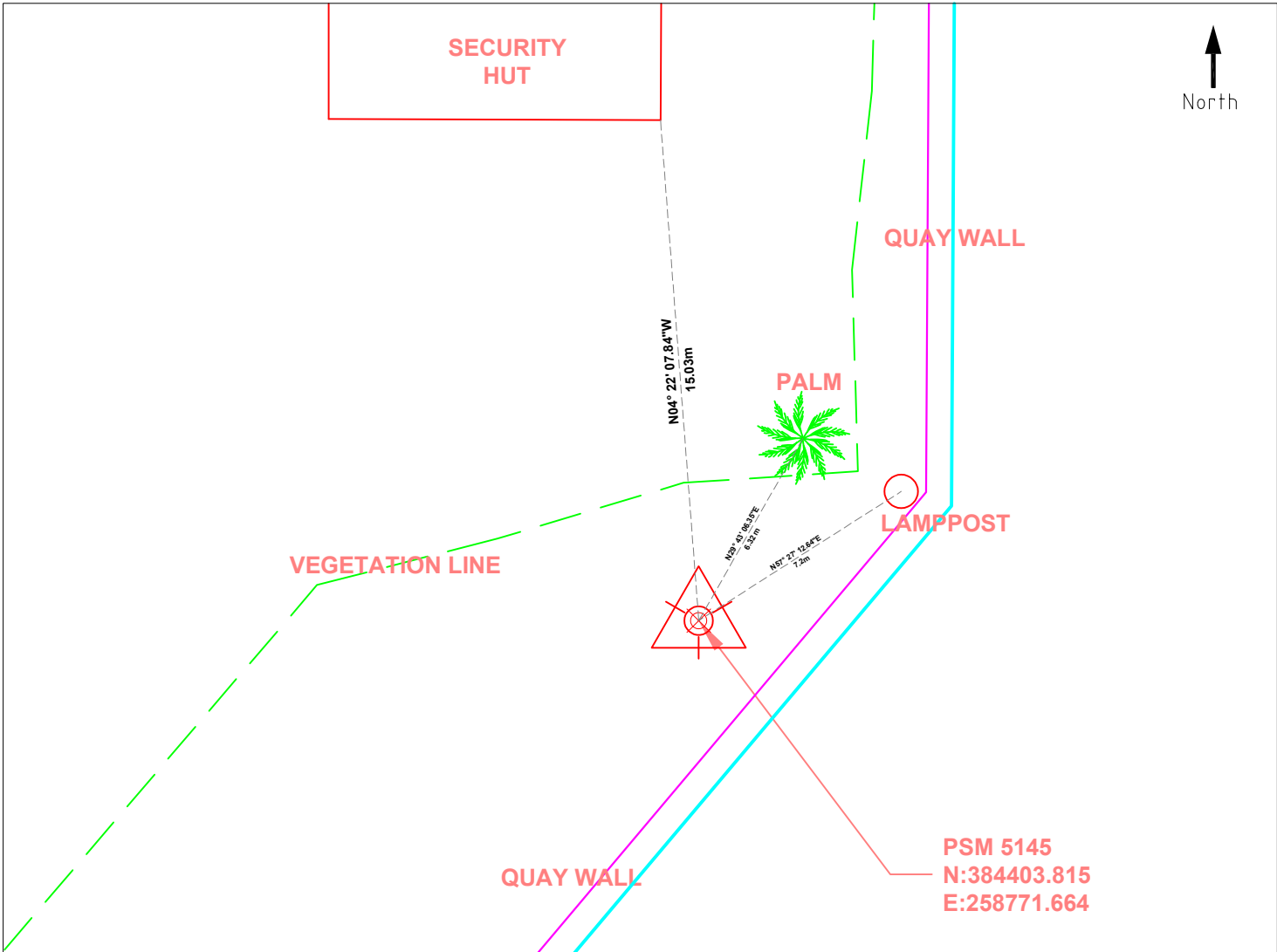

PSM 5145
 N:384403.815
 E:258771.664

Sketched by: Abdulla

Scale: Not to Scale

Date: 10 AUGUST 2021

MALDIVES LAND SURVEY AUTHORITY

MINISTRY OF HOUSING AND INFRASTRUCTURE
 Office (PABX): +(960) 3004300, Fax: +(960) 3004254
 Email: survey@housing.gov.mv
 Web: www.surveyofmaldives.gov.mv,
 Ameen Magu, Maafannu, Male', 20392, Maldives.



| | | |
|---|----------------------|----------|
| CONTROL POINT DETAILS | Station Number | PSM 5146 |
| Coordinate Information | | |
| Geodetic | Grid | |
| WGS 84 | UTM Zone 43 | |
| Lat: 3°28'34.52536"N | E: 258778.206m | |
| Long: 72°49'43.50289"E | N: 384512.821m | |
| Ellp Height: -82.748 | Orth Height: + 0.876 | |
| Island Name: ADH. Holiday Island Resort & Spa | Date: 7 August 2021 | |





Monument description & method of survey:

- Monument Type A as in Technical Brief
- Stainless steel plate fixed to concrete by Four bolts
- Horizontal coordinates fixed by GNSS Static survey.
- Elevation reduced relative to ellipsoid height difference , reference to PSM 5145 which was corrected to Meanwater level by tide prediction table (Hulhule)
- PSM 5140 is 0.35m below ground Level

General site condition & access:

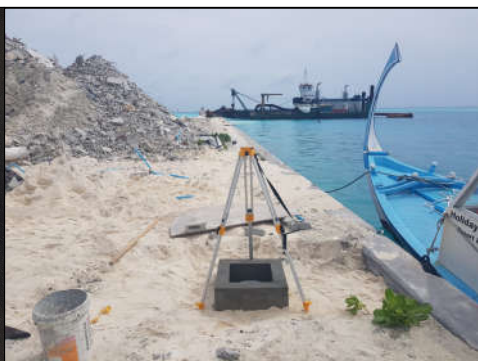
- Easily accessible area with wide angle of sky visibility
- Located at the east side harbor quaywall
- Situated near approximately mid of the Harbor Quay wall

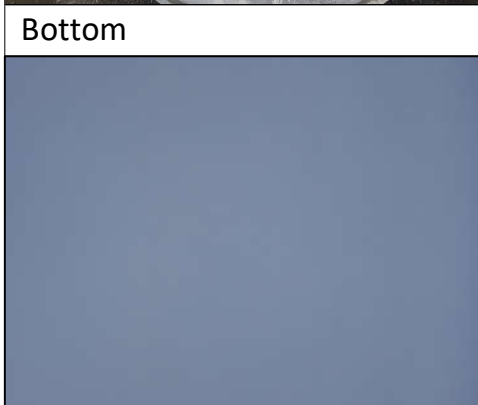
Owner: ADH. Holoiday Island Resort & Spa

| | | |
|--|--|---|
|  |  |  |
| Bottom | North Height 1.5m / Distance 2m | East Height 1.5m / Distance 2m |
|  |  |  |
| Up Height 1.5m | South Height 1.5m / Distance 2m | West Height 1.5m / Distance 2m |

SITE INFORMATION

Station Number

| | | | | | | |
|---|---|---|---|---|---|---|
| P | S | M | 5 | 1 | 4 | 6 |
|---|---|---|---|---|---|---|

Station Horizon Mask

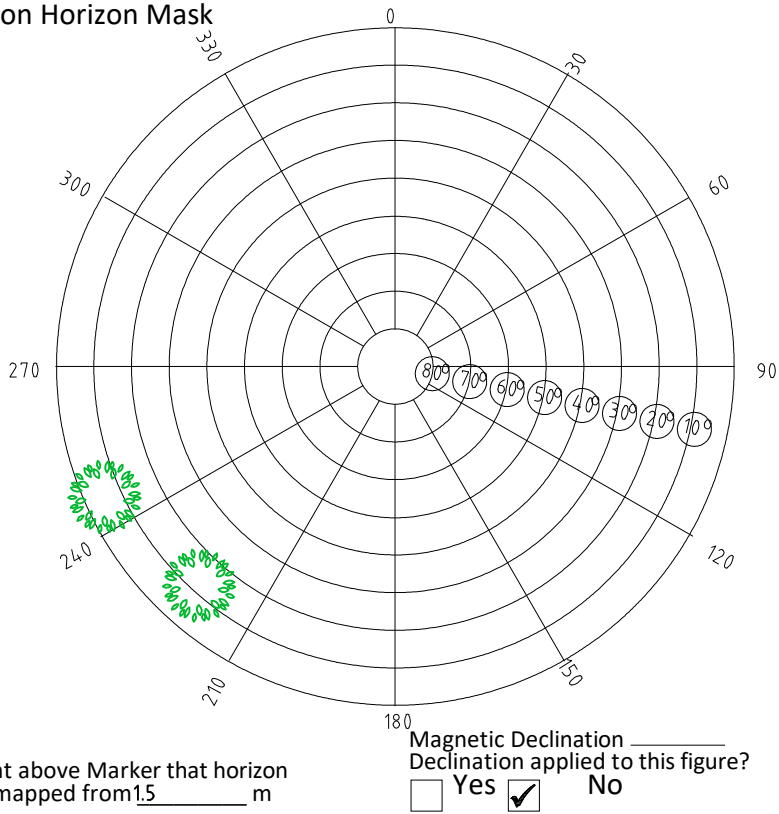

Height above Marker that horizon was mapped from 1.5 m

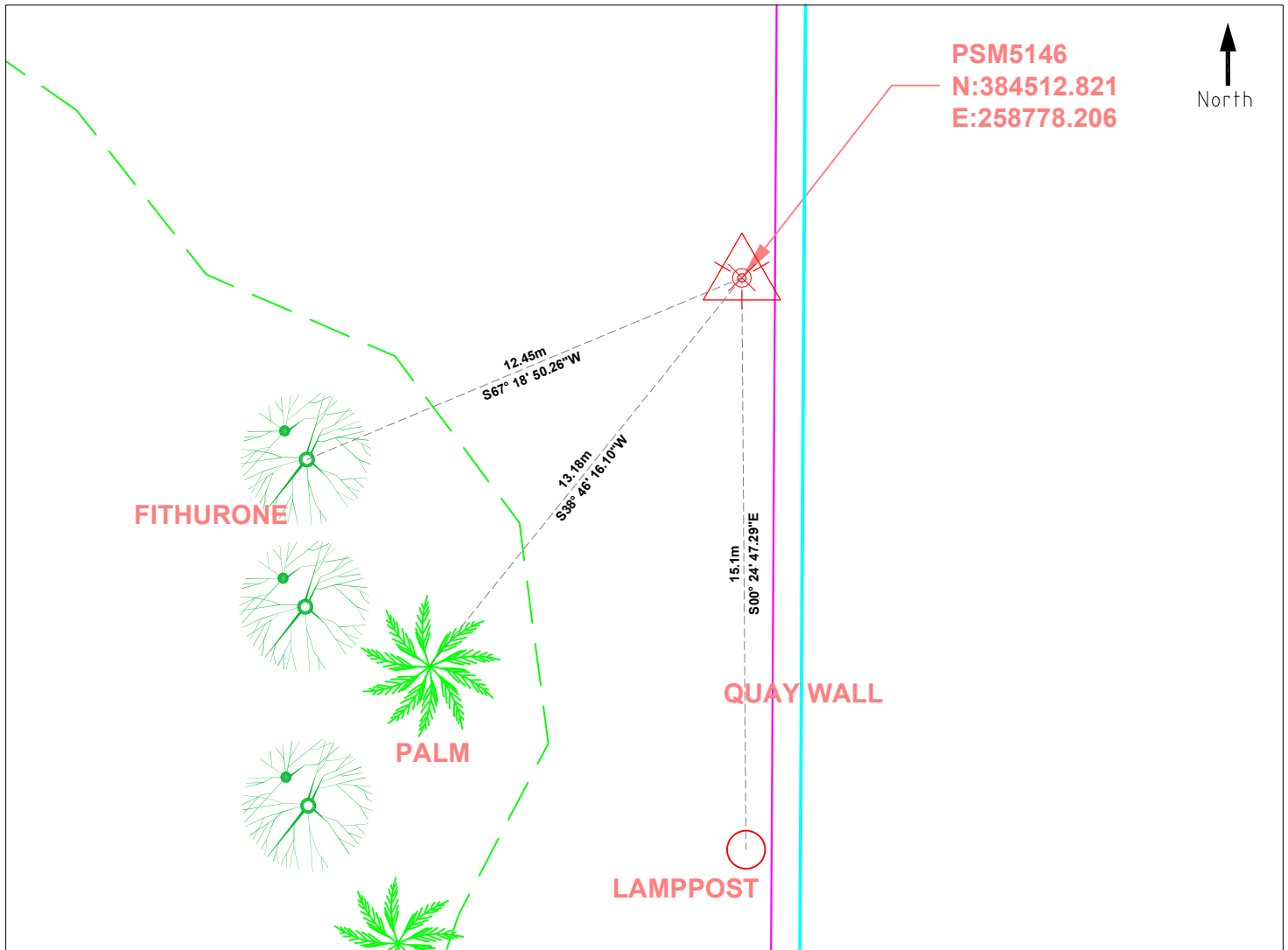
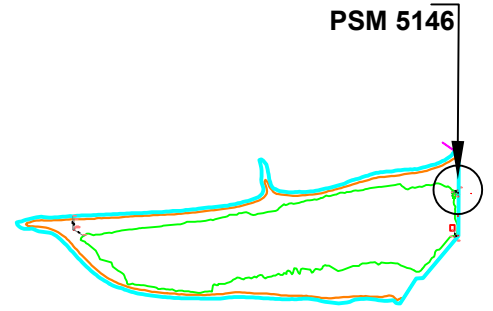

Sketched by: Abdulla

Scale: Not to Scale

Date: 10 AUGUST 2021

MALDIVES LAND SURVEY AUTHORITY

MINISTRY OF HOUSING AND INFRASTRUCTURE
 Office (PABX): +(960) 3004300, Fax: +(960) 3004254
 Email: survey@housing.gov.mv
 Web: www.surveyofmaldives.gov.mv,
 Ameenee Magu, Maafannu, Male', 20392, Maldives.



| | | |
|---|----------------------|----------|
| CONTROL POINT DETAILS | Station Number | PSM 5147 |
| Coordinate Information | | |
| Geodetic | Grid | |
| WGS 84 | UTM Zone 43 | |
| Lat: 3°28'31.48274"N | E: 257899.438m | |
| Long: 72°49'15.04815"E | N: 384421.357 m | |
| Ellp Height: -82.884 | Orth Height: + 0.740 | |
| Island Name: ADH. Holiday Island resort & Spa | Date: 7 August 2021 | |







Monument description & method of survey:

- Monument Type A as in Technical Brief
 - Stainless steel plate fixed to concrete by Four bolts
 - Horizontal coordinates fixed by GNSS Static survey.
 - Elevation reduced relative to ellipsoid height difference reference to PSM 5145 which was corrected to Meanwater level by tide prediction table.
- PSM 5147 is 0.4m below ground Level

General site condition & access:

- Easily accessible area with wide angle of sky visibility
- Located at the west side of the island.
- Situated at the empty ground of west side of the island.
- There are no fixed structures or Trees nearby to measure the distance to PSM

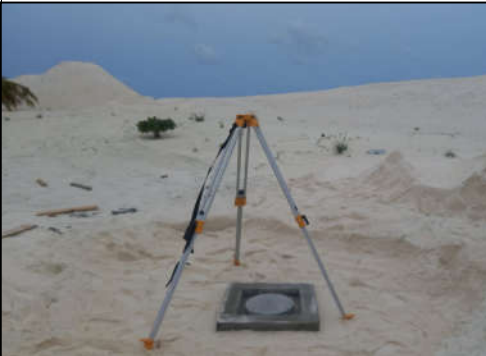
Owner: ADH. Holiday Island Resort & Spa

| | | |
|--|--|---|
|  |  |  |
| Bottom | North Height 1.5m / Distance 2m | East Height 1.5m / Distance 2m |
|  |  |  |
| Up Height 1.5m | South Height 1.5m / Distance 2m | West Height 1.5m / Distance 2m |

SITE INFORMATION

Station Number

| | | | | | | |
|---|---|---|---|---|---|---|
| P | S | M | 5 | 1 | 4 | 7 |
|---|---|---|---|---|---|---|

Station Horizon Mask

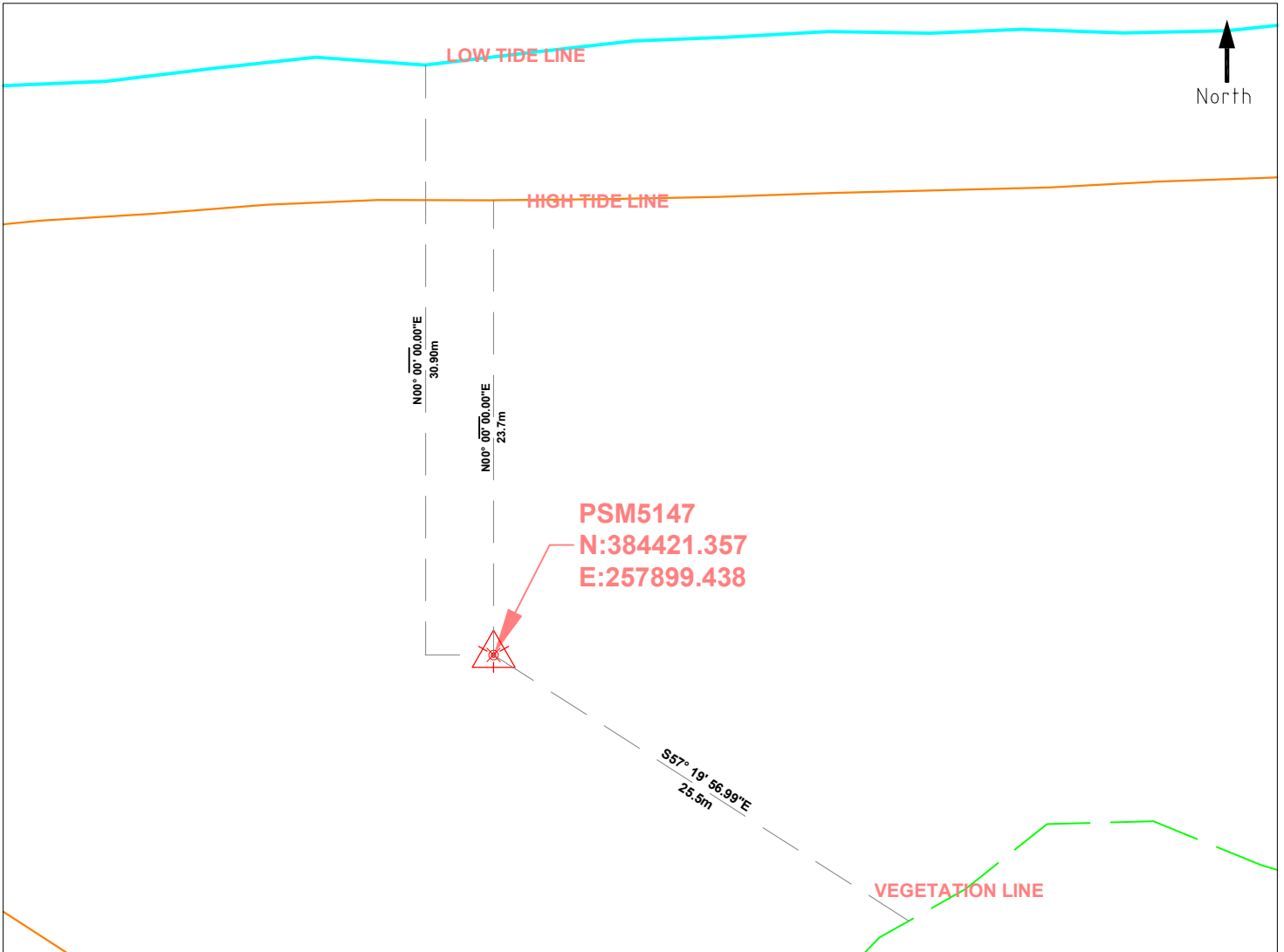
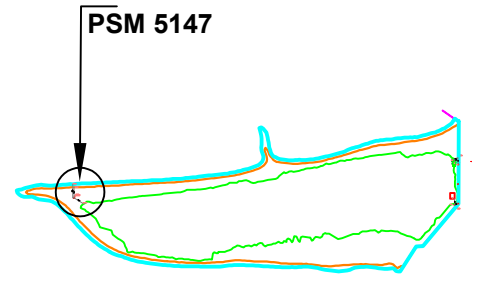
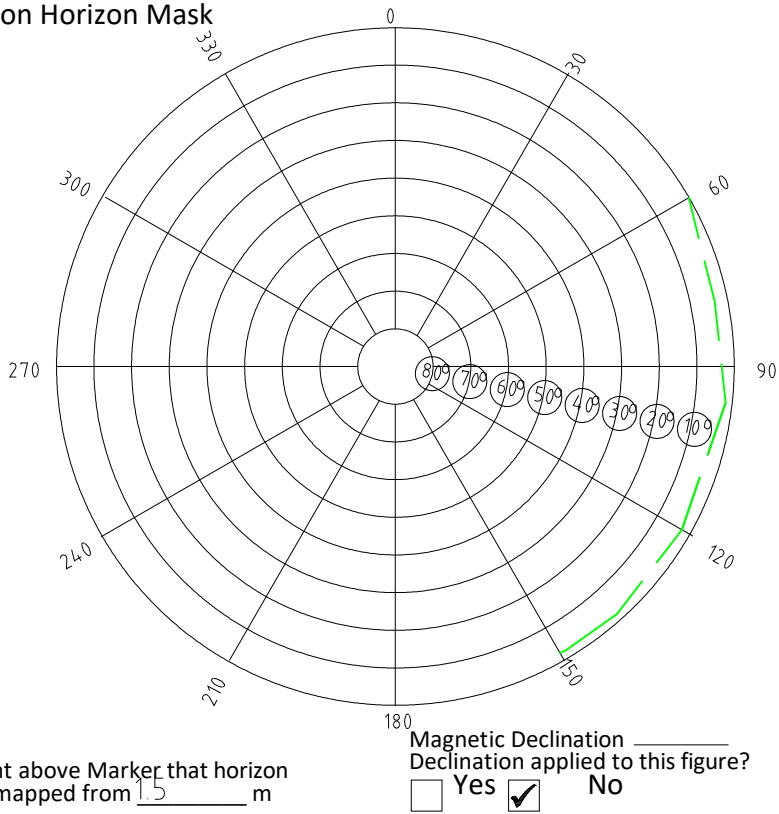

Sketched by: Abdulla

Scale: Not to Scale

Date: 10th AUGUST 2021